

**INSTALLATION INFORMATION**  
 3 - 2.5T DOGBONE STYLE LIFTING ANCHORS  
 WEIGHT: 4700 LBS / 2132 KG

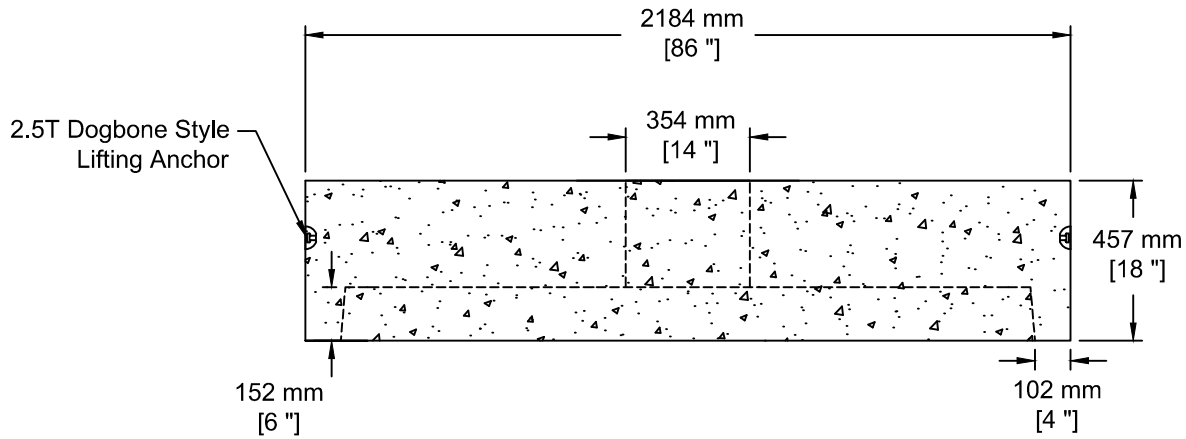

TEL: 250-495-7556  
 socp@socp.ca  
 www.socp.ca

**1800 ID (72") Manhole Lid  
 - B19 Op**

**Product #  
 0377-B19**