

INSTALLATION INFORMATION
DESIGN SPECIFICATION - ASTM C478
3 - 2.5T DOGBONE STYLE LIFTING ANCHORS
WEIGHT: 1800 LBS / 820 KG

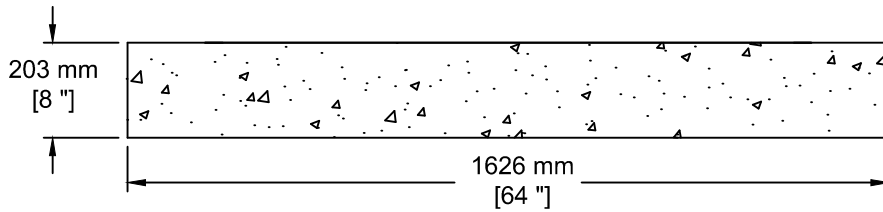

TEL: 250-495-7556
socp@socp.ca
www.socp.ca

1050 (42")
Precast Manhole Base

Product #

0332