

INSTALLATION INFORMATION

TANK - SPREADER BAR & CABLES FOR HANDLING
 LID /c 4 - 3/8" R-ANCHORS FOR HANDLING
 GASKET: CONSEAL BUTYL SEALANT
 WEIGHT: LBS / KG (LID)
 WEIGHT: LBS / KG (TANK)

DESIGN SPECIFICATION
RESIDENTIAL LOADING

BURIAL DEPTH - **NO GREATER THAN 1M**
 MANUFACTURED IN ACCORDANCE WITH: CSA A23.4, B-66
 ASTM C1227

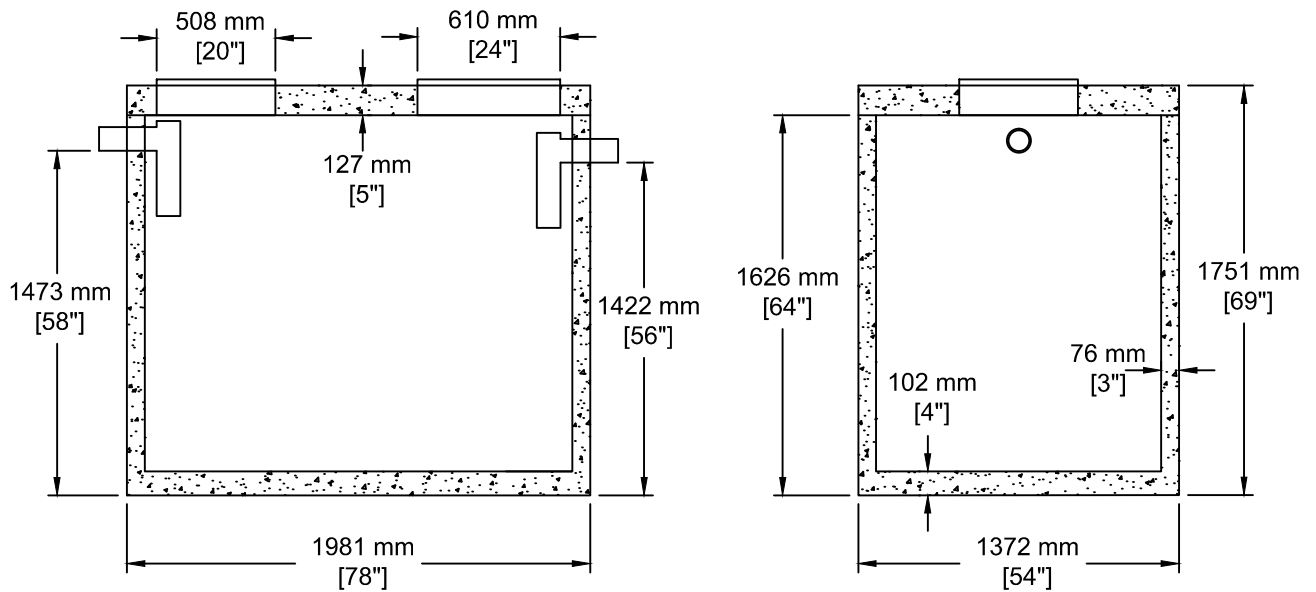

TEL: 250-495-7556
 socp@socp.ca
 www.socp.ca

TS-1Ch 2954 litres (650 Gal)
 Septic Tank

Product #

0108