

INSTALLATION INFORMATION

3 - 2.5T DOGBONE STYLE LIFTING ANCHORS
 WEIGHT: 1122 LBS / 509 KG

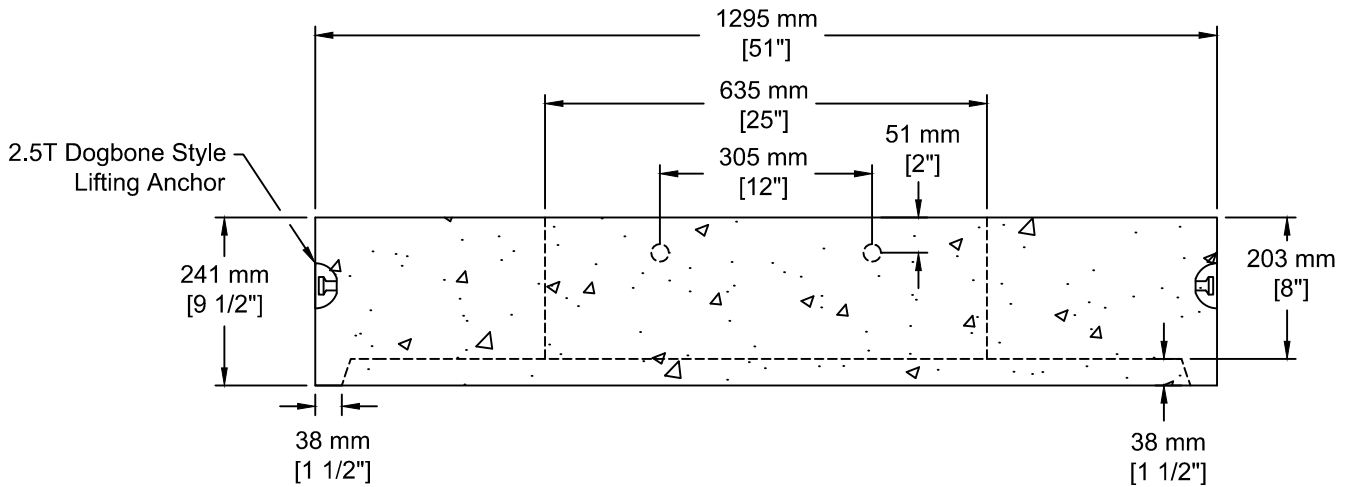

TEL: 250-495-7556
 socp@socp.ca
 www.socp.ca

1050 ID (42") Manhole Lid
 - 635 mm Op

Product #
0326