

INSTALLATION INFORMATION
3 - 2.5T DOGBONE STYLE ANCHORS
WEIGHT: 2168 LBS / 983 KG

2.5T Dogbone Style
 Lifting Anchor

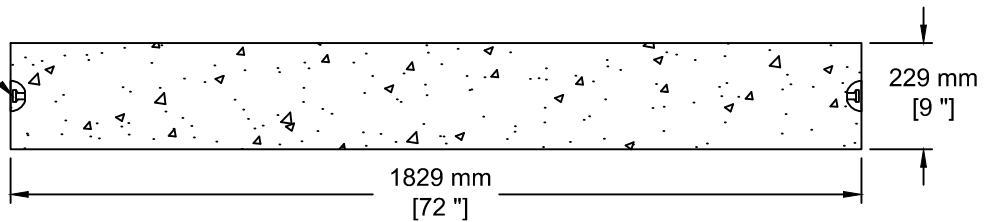

TEL: 250-495-7556
 socp@socp.ca
 www.socp.ca

Box 419, 11602 - 115 st Osoyoos, BC V0H 1V0

FAX: 250-495-3556

1200 ID (48") Drywell Base - 9"
1524 mm OD (60") x 0.23vm

Product #

0270-9