

INSTALLATION INFORMATION

2 - 2.5T DOGBONE STYLE LIFTING ANCHORS

28 DRAIN HOLES

WEIGHT: 681 LBS / 309 KG

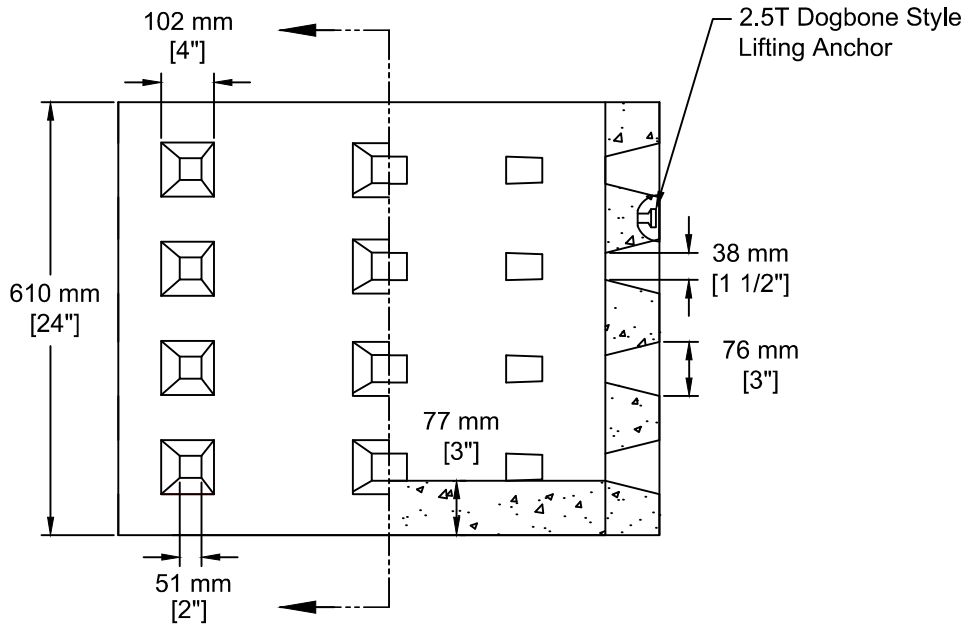

TEL: 250-495-7556
 socp@socp.ca
 www.socp.ca

**600 ID (24") 0.61vm Drywell
 - IB c/w Inside Base**

Product #

0250-IB